

RR 212h

GENERAL DESCRIPTION

CSC RR 212h is a relatively compact, two-way and bi-amped, high-powered loudspeaker. With a 40 degree vertical and a 60 degree horizontal dispersion, it gives a smooth coverage of 120 degree, and it is suitable for a crowd size of around 2000 people.

Perfect for live shows and dance performances, it is designed for power and voice propagation. Its stunning performance and exceptional sound come from a customized dual 12" (300mm) low-frequency transducer with a 3" (77 mm) voice coil. The high-frequency section is reinforced with a powerful 2" (50 mm) compression driver having a 2.5" (65 mm) voice. These are mounted on a constant directivity rotatable 60° x 40° horn.

Crafted with Baltic Birch, RR 212h is designed for touring and high-end installation, especially where serious SPLs are intended. A smart design and clever construction contribute to its relatively compact size. RR 212h comes with a 16 SWG grill for protection. Hardware accessories include flying rails on the side and at the back of the cabinet, a top hat and rubber feet. The product is available in non-toxic black texture paint.

The use of CSC Maestro MS 26 controller is recommended with RR 212h. Additionally, Cello RR 212h is a perfect match for Contrabass CR 218s, RRH 218s and RR 218s sub-woofers.



FEATURES

- ✓ Compact, two-way and bi-amped system
- ✓ Dispersion 60° x 40°
- ✓ Mounting rails on the sides and at the back of the cabinet
- ✓ Front ports
- ✓ Ideal for touring and high-end installation

SYSTEM APPLICATIONS

- ✓ Live bands and concerts
- ✓ Large auditoriums
- ✓ Worship centers
- ✓ Clubs
- ✓ Main PA for large installs

SYSTEM SPECIFICATIONS

Type	Bi-amped two-way medium throw mid high
Frequency Response (1)	65 Hz-17.5 kHz \pm 3 dB
Drivers	LF: 2 x12" (300 mm) with a 3" (77 mm) voice coil, HF: 2" (50 mm) compression driver with a 2.5" (65 mm) voice coil
Recommended Amplifier Upto	1500/ 160 Watts
Sensitivity (1 Watt/1 metre)	101/ 109 dB
Maximum SPL (9)	132 dB continuous, 136 dB Max
Nominal Impedance	4/ 8 Ohms
Dispersion	60° x 40°
Crossover	HPF 100 Hz
Enclosure	Baltic birch ply
Finish	Textured black paint
Protective Grille	Perforated steel
Connectors	2 x Neutrik NL8
Pin Connections	Input LF: \pm 3, HF: \pm 4; Link through LF: \pm 3, HF: \pm 4
Standard Colours	Black
Fittings	Flying rails, Top hat
Dimensions - Product	(W) 361 mm x (H) 841mm x (D) 418 mm
Dimensions - Including packing	(W) 431 mm x (H) 912 mm x (D) 488 mm
Horn	Rotatable
Rated Continuous Power AES	1000/ 80 Watts
Rated Maxium Power/Program Power	2000/ 160 Watts
Peak Power	4000/ 320 Watts
Accessories	Castors, Speaker poles, Felted waterproof covers, Flying hardware
Net weight	38 kgs
Shipping Weight	42 kgs

Mid highs measured on axis in full space @ 1 watt/1 meter using band limited pink noise. In the en-devour to continuously improve the product with design refinements introduced into existing products. Any current CSC product may differ in some respect from its published description. However this will always equal or exceed the original design specifications. Every CSC product is built to the highest standards and tested to ensure that it meets the performance criteria specified.

SAFETY INSTRUCTIONS

- ÿ When flying speakers, appropriate hardware and techniques must be employed for safely suspending the enclosures.
- ÿ Ensure all instructions that appear on specific loudspeaker datasheets are followed.
- ÿ All speaker hardware and flying apparatus must be regularly inspected for any visual or mechanical failure.
- ÿ Leave adequate distance between speakers and the audience. Refer to your local authority for Health and Safety guidance when using loudspeaker systems.
- ÿ The CSC digital controller should only be programmed by a CSC authorized technician. Do not use CSC loudspeaker systems without the correct controller and the program. If a system fails due to incorrect controller use, warranty is void.
- ÿ Protect your speakers and electronics from exposure to humidity, water or rain.
- ÿ CSC loudspeakers and electronics are covered against defects in workmanship or materials for a period of two years from the original date of purchase. The CSC warranty **does not cover** any item which in CSC's opinion has failed due to user abuse, accident, modifications.
- ÿ The defective item will be repaired/replaced with no charge for materials or labour. However the item should be adequately packed and dispatched, pre-paid, to a CSC authorized distributor/service center.

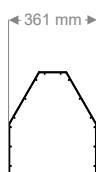

Top View

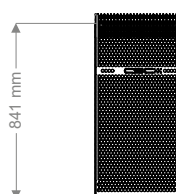

Front View

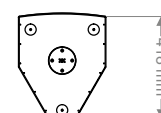

Bottom View